

MASTER PART MARK	VIN	AVAILABLE THICKNESS	YIELD MIN.	BLANK LENGTH	BLANK WIDTH	WEIGHT (LBS)
RPS18	A	0.060	50 KSI	18.00	2.00	0.61
SUB PART MARK	VIN	AVAILABLE THICKNESS	YIELD MIN.	BLANK LENGTH	BLANK WIDTH	WEIGHT (LBS)
(2) H1020	B	NA	NA	NA	NA	0.03

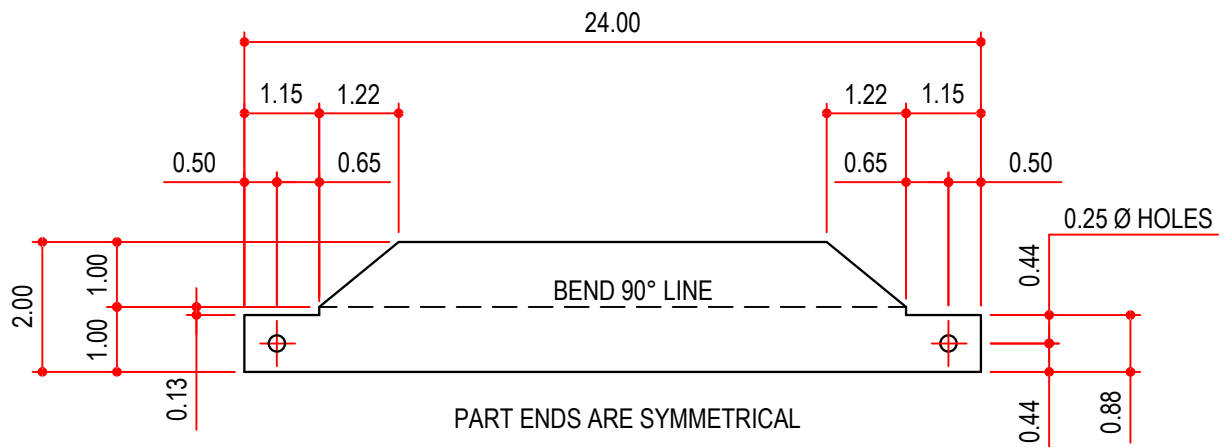

**NOTES:**

- 1) PART TO BE MANUFACTURED WITH PURLIN BRACING BUT PACKED IN TRIM CRATE (PREFERABLY WITH RPU121 WHEN POSSIBLE)
- 2) SUB PARTS WILL SHIP LOOSE.

**AVAILABLE COLORS**

GZ