

MASTER PART MARK	VIN	AVAILABLE THICKNESS	YIELD MIN.	BLANK LENGTH	BLANK WIDTH	WEIGHT (LBS)
PSC61	A	0.500	55 KSI	7.00	6.00	5.95

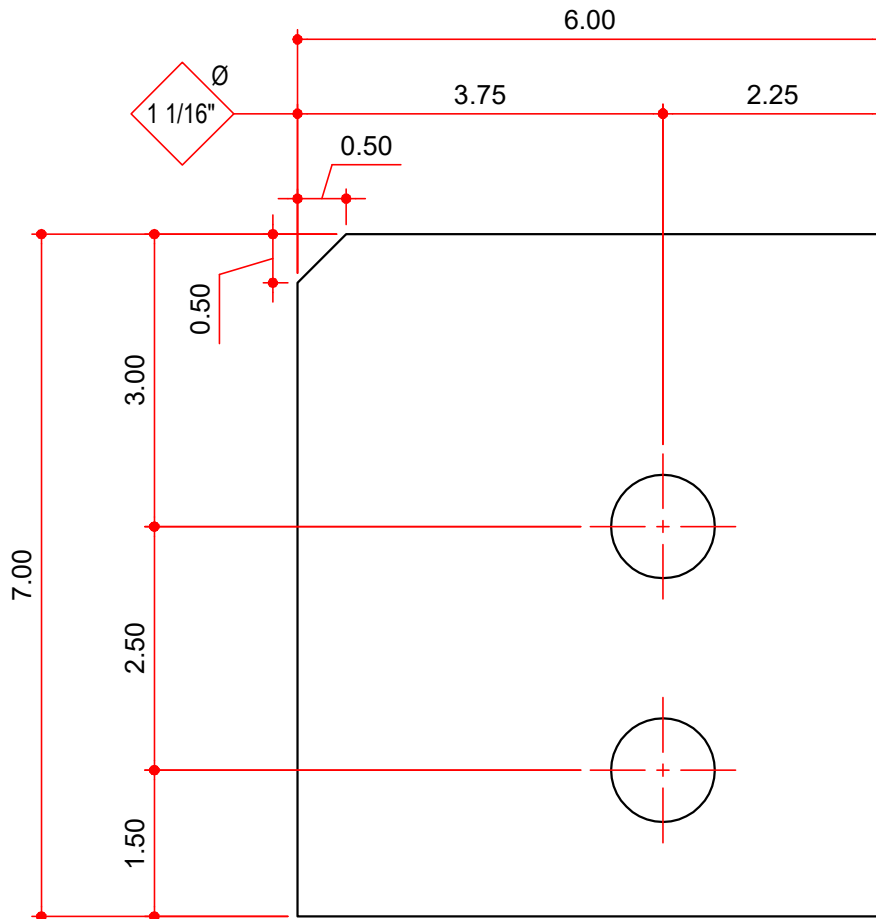

NOTES:

1) N/A

AVAILABLE COLORS

GP, HD, RP