

MASTER PART MARK	VIN	AVAILABLE THICKNESS	YIELD MIN.	BLANK LENGTH	BLANK WIDTH	WEIGHT (LBS)
PCC02	D	0.13 MIN.	55 KSI	17.50	5.00	3.10

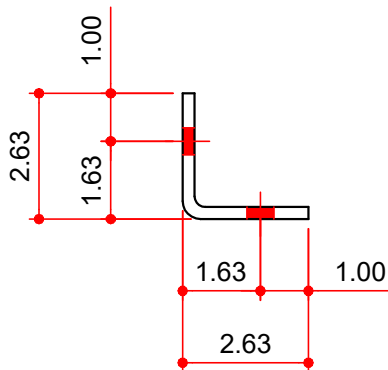
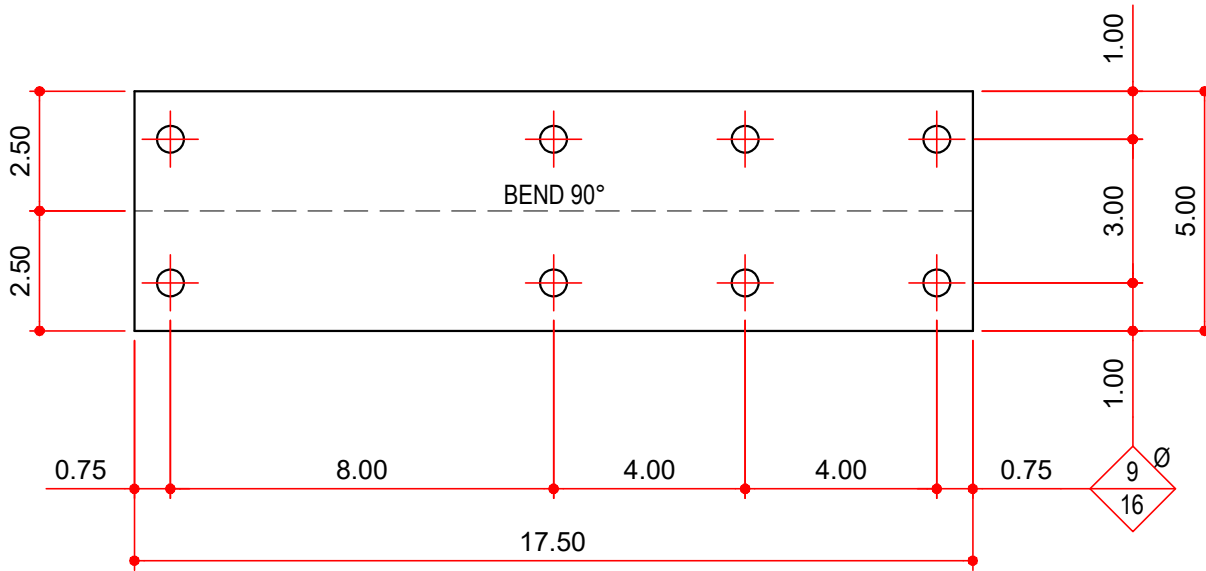

**NOTES:**

- 1) **\*\*NOTE FOR NBGMFG-SC: IT IS ACCEPTABLE TO CHANGE THE END DIMENSIONS FROM 0.75" TO 1.00" AND THE OVERALL LENGTH TO 18.00".**

**AVAILABLE COLORS**

GP, HD, RP