

MASTER PART MARK	VIN	AVAILABLE THICKNESS	YIELD MIN.	BLANK LENGTH	BLANK WIDTH	WEIGHT / FT (LBS)	ALLOWABLE SECONDARY SPACING
H9315	A	N/A (WALL ONLY)	N/A	64.00	N/A	8.26	(1) 5'-0"
H9320	A	N/A (WALL & ROOF)	N/A	128.00	N/A	16.52	(2) 5'-0" / (4) 2'-6" / (5) 2'-0"
H9325	A	N/A (ROOF ONLY)	N/A	140.00	N/A	18.07	(2) 5'-6"

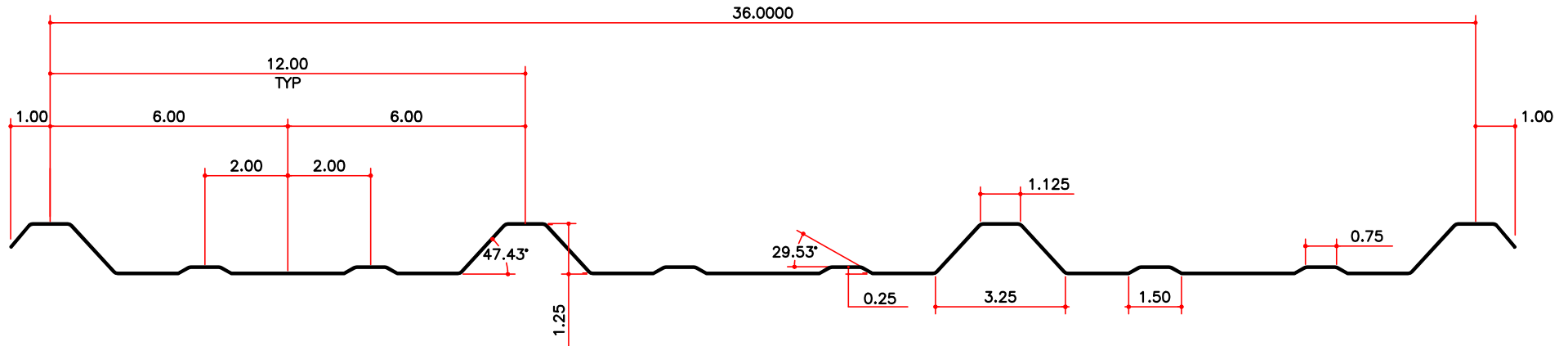

NOTES: BUYOUT

- 1) TRANSLUCENT PANELS ARE GLASTEEL ACRYLIT HIGH STRENGTH 8 OZ. FIBERGLASS.
- 2) TRANSLUCENT PANELS ARE GENERALLY A STOCKED ITEM, CHECK WITH YOUR PURCHASING DEPARTMENT.
- 3) H9315 & H9320 PANELS MAY BE USED ON WALLS, **H9315 NOT PERMITTED TO BE USED ON ROOF.**
- 4) UL RATING AND FLORIDA APPROVAL FOR ROOF ONLY APPLIES TO 5'-0" PURLIN SPACING.
- 5) SAFETY STICKERS ARE APPLIED TO H9320 & H9325 FOR ROOF APPLICATIONS. IF USED IN WALL APPLICATION STICKER WILL NEED BE REMOVED IN FIELD.
- 6) WHEN MODELING THESE IN TEKLA, USE THE SELECTION WITH THE PART MARK - RP OR RR FOR R-PANEL OR REVERSE R-PANEL. EXAMPLE H9315-RP = 64" UNIT WITH R-PANEL PROFILE AND H9315-RR = 64" UNIT WITH REVERSE R-PANEL PROFILE. THIS WILL ENSURE THAT THE PROFILE IS MODELED CORRECTLY.

AVAILABLE COLORS

NP