

MASTER PART MARK	VIN	AVAILABLE THICKNESS	YIELD MIN.	BLANK LENGTH	BLANK WIDTH	WEIGHT (LBS)
GCB09	C	0.188	55 KSI	7.50	5.00	2.00

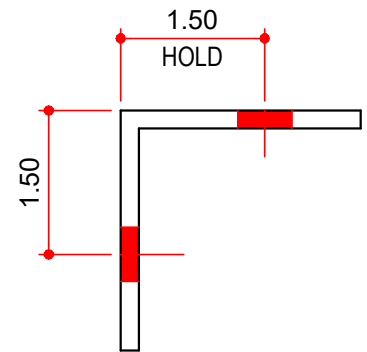
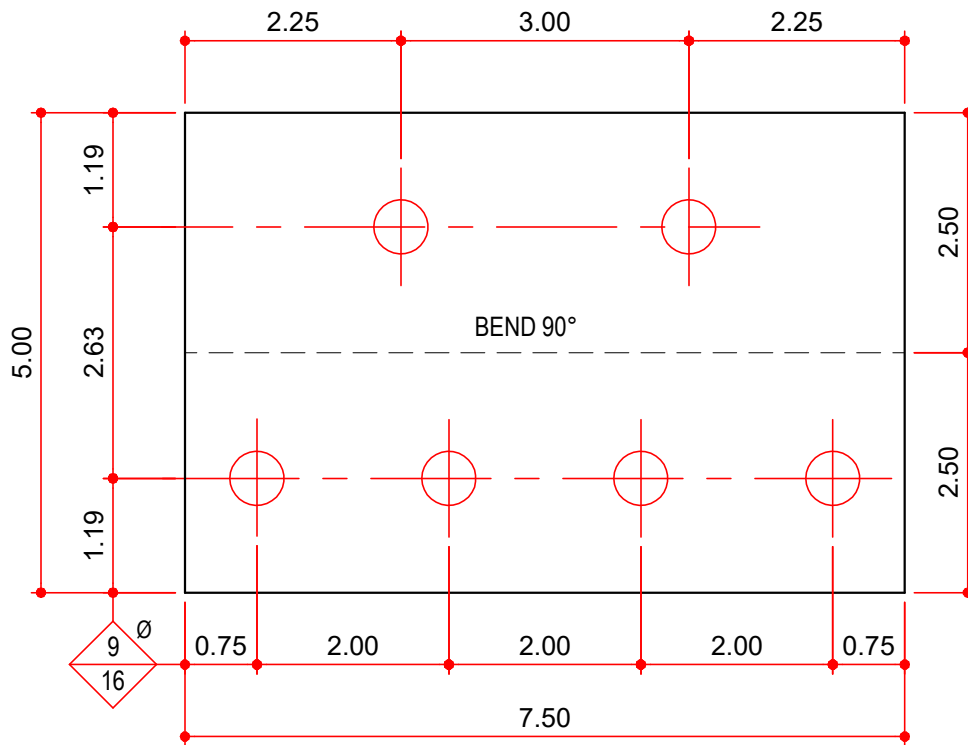

NOTES:

1) NOTE: THIS CLIP CAN ALSO BE MADE FROM 2 1/2" x 2 1/2" x 1/4" ANGLE

AVAILABLE COLORS

GP, HD, RP