

MASTER PART MARK	VIN	AVAILABLE THICKNESS	YIELD MIN.	BLANK LENGTH	BLANK WIDTH	WEIGHT
FBL01	B	0.188	55 KSI	6.00	6.00	1.92

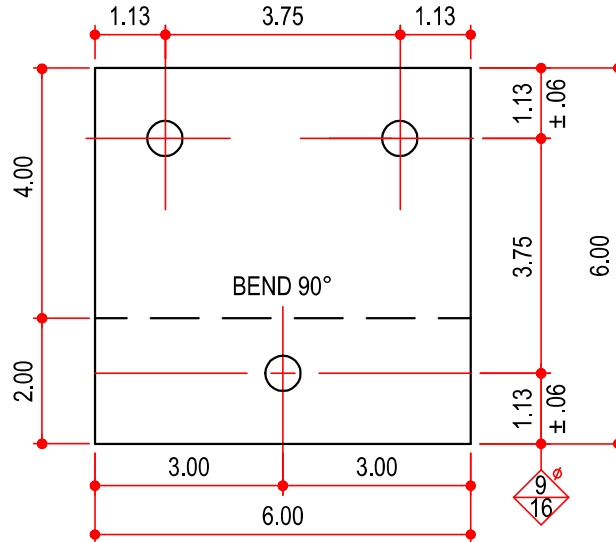
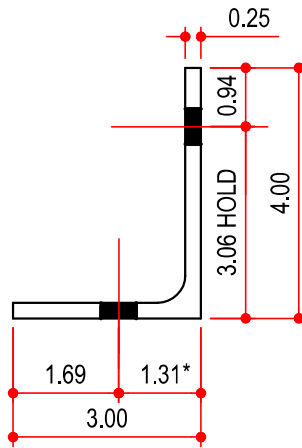
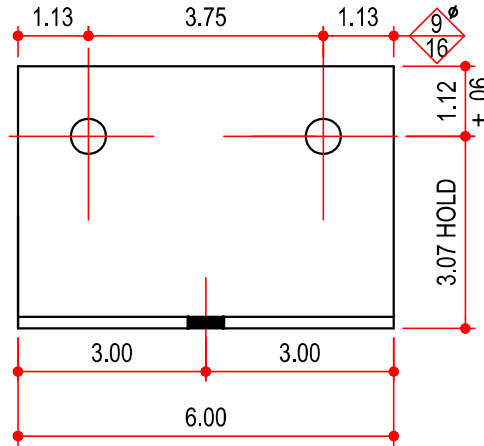
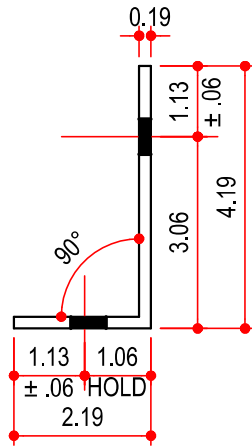

HOT ROLLED ANGLE OPTION  
\*- MINIMUM DIM DUE TO PRODUCTION LIMITATIONS

**NOTES:**

- 1) 3.00 X 4.00 X .25 H.R. ANGLE MAY BE SUBSTITUTED.

**AVAILABLE COLORS**

GP, HD, RP, NP