

MASTER PART MARK	VIN	AVAILABLE THICKNESS	YIELD MIN.	BLANK LENGTH	BLANK WIDTH	WEIGHT (LBS)
CBC04	A	0.50	36 KSI	7.00	5.00 X 3.00	7.47
SUB PART MARK	VIN	AVAILABLE THICKNESS	YIELD MIN.	BLANK LENGTH	BLANK WIDTH	WEIGHT (LBS)
(2) H0220	A	NA	NA	NA	NA	NA
(2) H0240	A	NA	NA	NA	NA	NA

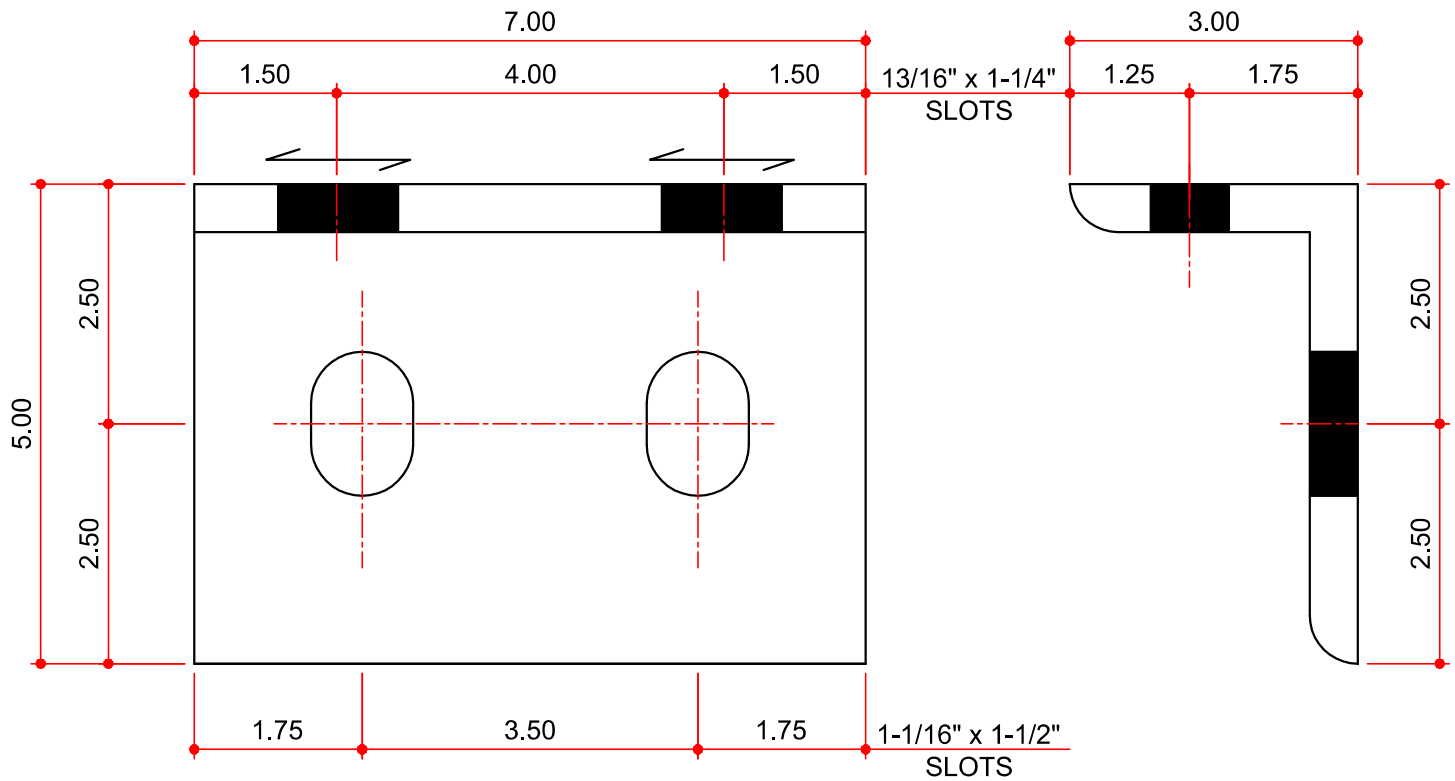

NOTES:

- 1) THIS CLIP IS UTILIZED AT THE HEAVY TIE-BACK CONNECTION.
- 2) THE SLOTS THAT ARE 3.50" APART BOLT TO THE COLUMN FLANGE.
- 3) THE SLOTS THAT ARE 4" APART BOLT TO THE CRANE BEAM.
- 4) REFERENCE DETAIL AH0160.

AVAILABLE COLORS

GP, HD, NP, RP