

MASTER PART MARK	VIN	AVAILABLE THICKNESS	YIELD MIN.	BLANK LENGTH	BLANK WIDTH	WEIGHT (LBS)
PTC06	C	0.188	55 KSI	6.00	6.00	1.92

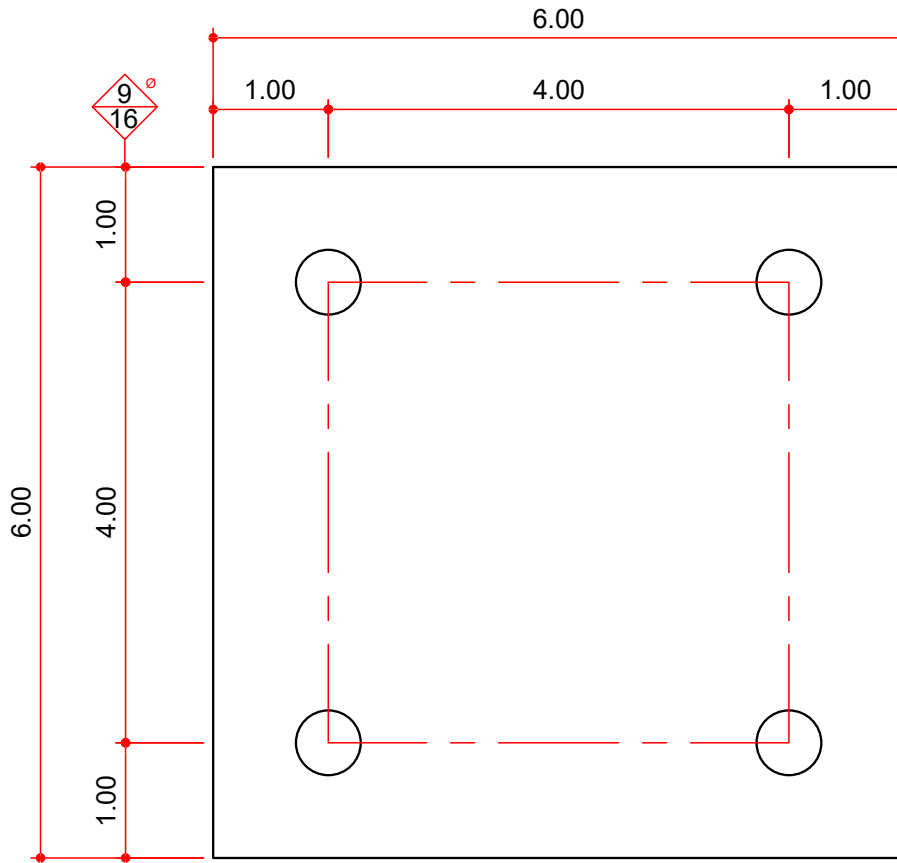

NOTES:

1)

AVAILABLE COLORS

GP, HD, RP, NP