

MASTER PART MARK	VIN	AVAILABLE THICKNESS	YIELD MIN.	BLANK LENGTH	BLANK WIDTH	WEIGHT (LBS)
PTC03	C	0.125	55 KSI	6.00	8.50	1.81

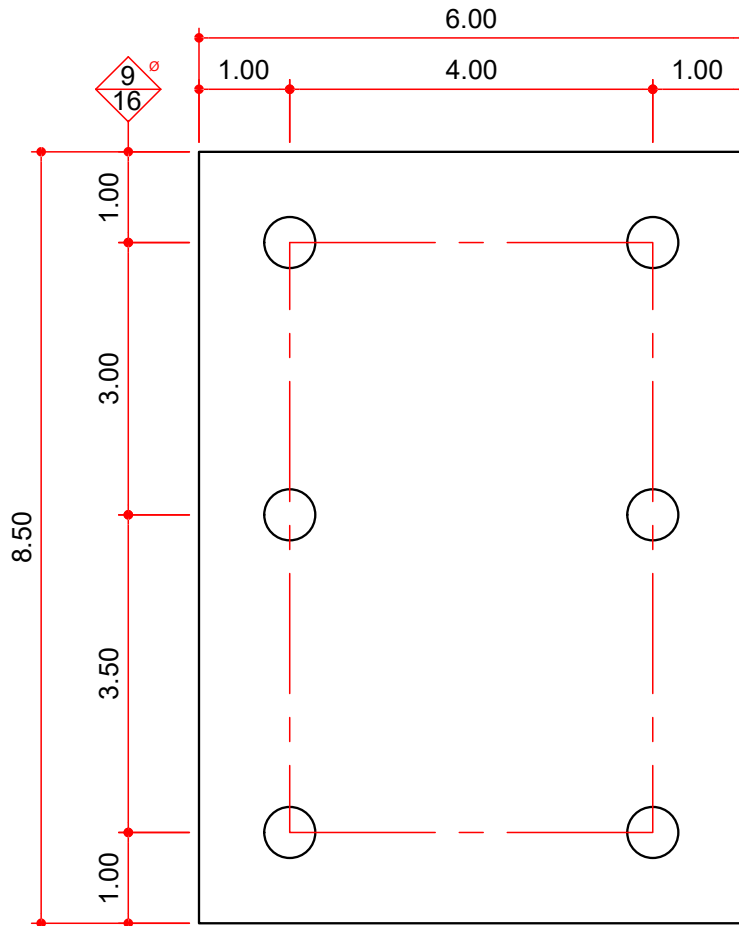

NOTES:

1)

AVAILABLE COLORS

GP, HD, RP, NP