

MASTER PART MARK	VIN	AVAILABLE THICKNESS	YIELD MIN.	BLANK LENGTH	BLANK WIDTH	WEIGHT (LBS)
GCB10	C	0.188	55 KSI	5.50	5.00	1.46

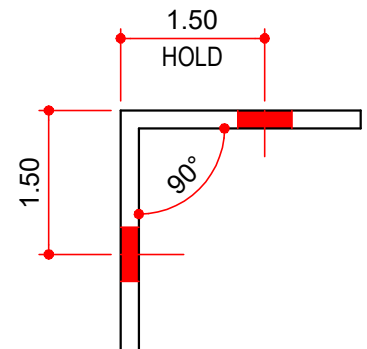
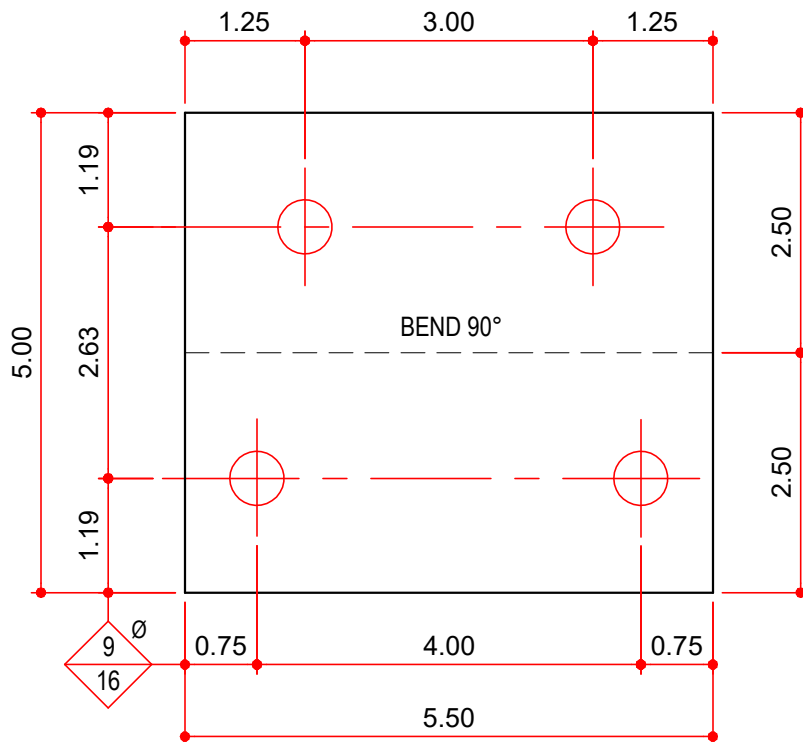

NOTES:

1) THIS CLIP CAN ALSO BE MADE FROM 2 1/2" x 2 1/2" x 1/4" ANGLE

AVAILABLE COLORS

GP, HD, RP